



# ROBINSON DJERBA BAHIYA

FACTSHEET

**FOR INTERNAL USE ONLY.****HOTEL CONTACT DETAILS**

Resort / Hotel Name	<b>ROBINSON DJERBA BAHIYA</b>
Star Rating	<b>4</b>
Season Open	<b>Summer</b>
Display Line Address	<b>Djerba, Tunisia Zone Touristique Ennadhour, Midoun 4116, Djerba 4116 Tunisia</b>
Tel	<b>0021 67 57 45 500</b>
E-Mail	<b>djrbabahiya@robinson.com</b>
Homepage	<b><a href="https://www.robinson.com/en/en/resort-holiday/tunisia/djerba-bahiya/club-details/">https://www.robinson.com/en/en/resort-holiday/tunisia/djerba-bahiya/club-details/</a></b>

**GENERAL**

Welcome to the golden beaches of Tunisia on the delightful island of Djerba. Enjoy a fairytale family vacation in the Arabian Nights atmosphere of the beautiful ROBINSON CLUB DJERBA BAHIYA. In the mild, sunny climate of this stunning island, our new club has everything you dream of in an all-inclusive beach vacation in which adults and children alike can relax and enjoy all the activities on offer.

**USPS**

- **Kids & Teens**

The needs of our young guests are a top priority at ROBINSON: Children aged three or older can spend wonderful, adventure-filled days at ROBY CLUB, where Minis (3 to 5 years of age) and Maxis (6 to 7 years of age) are cared for age-appropriately by professional staff every day between 9 a.m. and 9 p.m.

- **WellFit**

Our WellFit program combines fitness and wellness. You choose between working out and relaxing: With its new WellFit active facilities featuring a gym, GroupFitness and indoor cycling areas, and outdoor terrace, ROBINSON DJERBA BAHIYA is the perfect vacation destination for a comprehensive workout.

- **Tennis**

ROBINSON DJERBA BAHIYA is the perfect vacation resort for tennis enthusiasts, with 7 clay courts for marathon matches. Racket rentals and court use included (additional charge applies for tennis balls). Beginners can learn the ropes at the ROBINSON tennis school (additional charge). We also have rackets for sale for guests who prefer to play with their own.

## FOR INTERNAL USE ONLY.

## HOTEL TYPE

All Inclusive Hotel  
 Beach  
 Club  
 Club/Resort Hotel  
 Family Friendly  
 Holiday Hotel  
 Holiday Resort  
 Sports & Activities  
 Sustainable Initiatives

## ESPECIALLY SUITABLE FOR

Couples  
 Families  
 Groups  
 Singles

## LOCATION

At the Seaside  
 On/By the Beach

## KEY FACTS

Number of Buildings (Guest House, Main Building)	6
Buildings Stories	2
Property Size	94,500m <sup>2</sup>
Date of Last Renovation	2015
Degree of Latitude	33°49'23.3
Degree of Longitude	11°03'13.7
Total Number of Rooms	396
Total Number of Beds	825

## DIRECTIONS

Directions From Airport	Djerba-Zarzis (DGA), 30km away, approx. 40 min transfer
Free Airport Transfer	✓ Within TUI Package
Paid For Airport Transfer	✓ On request with club

## FOR INTERNAL USE ONLY.

## ROOM DETAILS

## TWIN/DOUBLE ROOM



## EXTERNAL BUILDING

Room Code	DSX1
Dimensions	22m <sup>2</sup>
Bed Size	200x200cm, 70x180cm
Details	Min/Max. occupancy: 3 adults and 1 infant under 2 years of age

## ROOM FACILITIES

## NOTES

Accessibility Adapted Bathroom	✓
Air Conditioning	Individually adjustable, depending on the season
Balcony/Terrace	✓
Bathroom with Shower	✓
Desk	✓
Flat Screen TV	✓
Fridge	✓
Hairdryer	✓
Internet Access	✓
Makeup Mirror	✓
Room Safe	Free of charge
Satellite TV	✓
Telephone	✓
Wi-Fi	WIFI is available in many public areas and in some rooms

## DOUBLE ROOM



## EXTERNAL BUILDING

Room Code	DZX1 & DZM1
Dimensions	22m <sup>2</sup>
Bed Size	200x200cm, 70x180cm
View	DZX1- Garden View, DZM1 Seaview
Details	Min/Max. occupancy: 3 adults and 1 infant under 2 years of age

## ROOM FACILITIES

## NOTES

Accessibility Adapted Bathroom	✓
--------------------------------	---

## FOR INTERNAL USE ONLY.

ROOM FACILITIES	NOTES
Air Conditioning	Individually adjustable, depending on the season
Balcony/Terrace	✓
Bathroom with Shower	✓
Desk	✓
Flat Screen TV	✓
Fridge	✓
Hairdryer	✓
Internet Access	✓
Makeup Mirror	✓
Room Safe	Free of charge
Satellite TV	✓
Wi-Fi	WIFI is available in many public areas and in some rooms

## DOUBLE ROOM



## EXTERNAL BUILDING

Room Code	DZE1
Dimensions	22m²
Bed Size	200x200cm, 70x180cm
Details	Min/Max. occupancy: 2 adults and 1 infant under 2 years of age

ROOM FACILITIES	NOTES
Accessibility Adapted Bathroom	✓
Air Conditioning	Individually adjustable, depending on the season
Balcony/Terrace	✓
Bathroom with Shower	✓
Desk	✓
Flat Screen TV	✓
Fridge	✓
Hairdryer	✓
Internet Access	✓
Makeup Mirror	✓
Room Safe	Free of charge
Satellite TV	✓
Telephone	✓

## FOR INTERNAL USE ONLY.

## ROOM FACILITIES

## NOTES

Wi-Fi

WIFI is available in many public areas and in some rooms

## SUPERIOR DOUBLE ROOM

## EXTERNAL BUILDING



Room Code

DZX2

Dimensions

30m<sup>2</sup>

Bed Size

200x200cm, 190x200cm

Details

Min/Max. occupancy: 2 adults and 2 children aged 2–14 years or max. 3 adults and 1 infant under 2 years of age

## ROOM FACILITIES

## NOTES

Accessibility Adapted Bathroom

✓

Air Conditioning

Individually adjustable, depending on the season

Balcony/Terrace

✓

Desk

✓

Flat Screen TV

✓

Fridge

✓

Hairdryer

✓

Internet Access

✓

Makeup Mirror

✓

Room Safe

Free of charge

Satellite TV

✓

Sofa Bed

✓

Telephone

✓

Wi-Fi

WIFI is available in many public areas and in some rooms

INTERCONNECTING 2  
BEDROOM FAMILY ROOM

## EXTERNAL BUILDING

## FOR INTERNAL USE ONLY.



Room Code	FZX2
Dimensions	42m <sup>2</sup>
Bed Size	200x200cm
Details	Suitable for max. 3 adults, 1 child/teenager aged 2–17 and 1 infant under 2 years of age

## ROOM FACILITIES

## NOTES

Accessibility Adapted Bathroom	✓
Air Conditioning	Individually adjustable, depending on the season
Balcony/Terrace	✓
Bathroom with Shower	✓
Flat Screen TV	✓
Fridge	✓
Hairdryer	✓
Internet Access	✓
Makeup Mirror	✓
Room Safe	Free of charge
Rooms with Connecting Door Available	✓
Satellite TV	✓
Separate Bedroom	✓
Separate Toilet	✓
Telephone	✓
Wi-Fi	WIFI is available in many public areas and in some rooms

## FAMILY ROOM

## EXTERNAL BUILDING

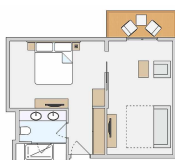

Room Code	FZX1, FZM1
Dimensions	30m <sup>2</sup>
Bed Size	200x200cm, 150x190cm
View	FZX1 = Garden, FZM1=Seaview
Details	Min/Max. occupancy: 2 adults and 2 children aged 2–14 or 3 adults and 1 infant under 2 years of age

## ROOM FACILITIES

## NOTES

Accessibility Adapted Bathroom	✓
Air Conditioning	Individually adjustable, depending on the season

## FOR INTERNAL USE ONLY.

ROOM FACILITIES	NOTES
Balcony/Terrace	✓
Bathroom with Shower	✓
Flat Screen TV	✓
Fridge	✓
Hairdryer	✓
Internet Access	✓
Makeup Mirror	✓
Room Safe	Free of charge
Satellite TV	✓
Separate Bedroom	✓
Telephone	✓
Wi-Fi	WIFI is available in many public areas and in some rooms

## FOR INTERNAL USE ONLY.

## EATING AND DRINKING

## KEY FACTS

• Number of Restaurants	2
• Number of Bars	4
Outdoor Food Services	Beach Restaurant
Main Restaurant	Buffet Restaurant
Bars	Main bar, Beach bar, Pool bar, Moroccan cafe
Speciality Restaurants	Beach restaurant

## CUISINE

## Board Basis

All Inclusive	✓
---------------	---

## Type of Restaurants &amp; Bars

Pool Bar	✓
----------	---

## Dietary/Lifestyle Requirements

Diabetic Friendly	✓
Gluten Free	✓
Vegan	✓
Vegetarian	✓
WellFood	✓

## Additional Options

Afternoon Tea	✓
Gala Dinner	✓
Late Breakfast	✓

## FOR INTERNAL USE ONLY.

## RESTAURANTS

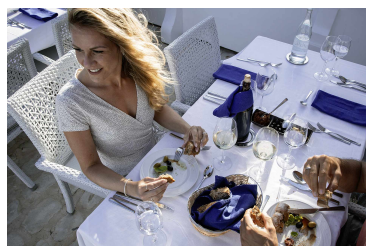

Name	Main restaurant
Details	Buffet Restaurant
Dresscode	Smart/casual, men must wear long trousers or tailored shorts for dinner
Opening Hours	Breakfast 07:00-11:00, Lunch 12:30-14:00, Dinner 19:00-21:00
Location	Main building



Name	Beach Restaurant
Details	Mediterranean & Local Cuisine
Reservation	Book via the ROBINSON app, with guest relations or at a kiosk
Dresscode	Smart/casual, men must wear long trousers or tailored shorts at dinner
Opening Hours	12:30-14:00 & 19:00-21:00
Location	On the beach
Specials	Additional charge

## BARS



Name	Main Bar
Details	Alcoholic and non-alcoholic beverages & cocktails
Opening Hours	11:00-00:00
Location	In the centre of the resort

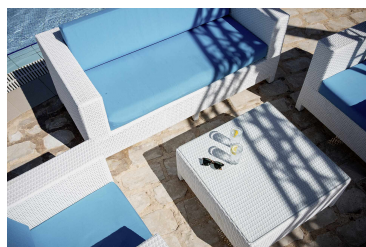

Name	Pool Bar
Details	Alcoholic and non-alcoholic beverages & cocktails
Opening Hours	10:00-02:00
Location	Main pool

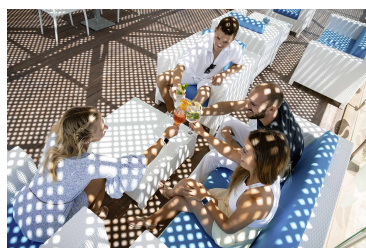
**FOR INTERNAL USE ONLY.**

Name	<b>Beach Bar</b>
Details	<b>Alcoholic and non-alcoholic beverages &amp; cocktails</b>
Opening Hours	<b>10:00-Sunset</b>
Location	<b>On the beach</b>

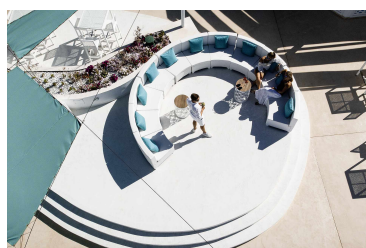

Name	<b>Moroccan Cafe</b>
Details	<b>Moroccan coffees &amp; delights at Cafe Maure</b>
Offerings	<b>Shisha available on request</b>
Opening Hours	<b>16:30-00:00</b>
Location	<b>Main building</b>

## FOR INTERNAL USE ONLY.

### ACTIVITIES & ENTERTAINMENT

All of the below activities are available on site, unless otherwise stated.

#### FITNESS

##### Included for free

Aerobics	14+
Aqua Fitness	16+
Dance Classes	14+
Group Fitness Classes	14+
Gym	14+
Hot Iron	16+
Indoor Cycling	16+
Pilates	14+
Power Plates	In the gym, 16+
Relaxation/Meditation	14+
Step Aerobics	14+
Stretch & Relax	14+
Trend Sports	14+
Yoga	14+

##### At extra cost

Personal Training

#### WELLNESS

##### Included for free

Relaxation Area	
Sauna	

##### At extra cost

Beauty Treatments	
Hamam	
Massages	
Spa	

#### WATERSPORTS

##### Included for free

**FOR INTERNAL USE ONLY.**

Catamaran	Bring with you a recognized catamaran certificate (or equivalent proficiency certificate and proof of experience) to hire catamaran equipment free of charge
Kitesurfing	Bring with you a recognized surfing certificate (or equivalent proficiency certificate and proof of experience) to hire catamaran equipment free of charge

**At extra cost**

Stand-up Paddling

**DAYTIME SPORTS & ACTIVITIES****Included for free**

Archery	16+
Darts	
Family Friendly Sports	
Football	
Table Tennis	
Tennis	7 clay courts for marathon matches, racket rentals and court use included (additional charge)
Volleyball	
Water Polo	

**At extra cost**

Excursions	With TUI
Golf	
Swimming Lessons	Sharky swim school

**EVENING ENTERTAINMENT****Included for free**

Cabaret	
Childrens Programme	
Comedy Nights	
Food Festivals	TASTEJam, fortnightly
Gala Night	ROB Carpet once a week
Live Music	
Musicals	
Parties	
Quizzes	
Sundowners	
Theatre Style Shows	

FOR INTERNAL USE ONLY.

At extra cost

Dance Shows

CHILDCARE

Included for free

Kids' Clubs	3-6 years, 7-9 years, 10-12 years
Teen Activities	13-15 & 16-17 years during school holidays

At extra cost

Babysitting Service	12€ per child per hour
---------------------	------------------------

## FOR INTERNAL USE ONLY.

## GENERAL HOTEL FACILITIES

Facility	Notes
Air Conditioning	
Baby Packs/Facilities	
Cots	
Disco/Night club	
Doctor / Nurse	
First Aid	
Golf Course	
Gym	
Hotel Shops	
Indoor Pool	
Kids' Club	
Library	
Minimart	
Outside Pool	
Parasols	
Playground	
Reception	
Smoking Area	
Sunbeds	
Sunloungers	
Sunset Bar	
Washing Machine	
Wi-Fi in Public Areas	

## CONGRESS &amp; CONFERENCE ROOMS

Quantity of Conference Rooms	1 Indoor theater
Total Capacity	350
No. of Pax U Plan	
No. of Pax Cabaret Style	
No. of Pax Theatre Style	
No. of Pax Boardroom Style	

## EQUIPMENT OF MEETING &amp; CONFERENCE ROOMS

**FOR INTERNAL USE ONLY.**
**SERVICES & LOCAL INFORMATION**

24-Hour Reception	
Beach/Pool Towels - Free	
Car Hire	
Change of Bedding	
Change of Towels	
Currency Exchange	
Excursion Information Desk	
Excursions, Tours, Attractions and Event Tickets	
Express Check-in/Out	
Hairdresser	In spa area
Hotel/Club Shops	
Hotel Doctor	
Laundry Service	Additional charge
Local Bus Service	
Luggage Storage	
Multi-lingual Personnel	French, German & English
Porter Service	
Support for Tour and Trip Planning	
Towels At The Beach	
Towels At The Pool	

**FACILITIES ON SITE / PROXIMITY TO HOTEL**

Facility	On Site	Notes
Beach	✓	Sandy beach
Bus Stop	✓	
City Centre		Houmt Souk center, approx. 20 km
Closest Airport		Djerba airport (DJE), approx. 30 km, 40 min. transfer time
Closest ATM		Midoun center, approx. 6 km
Closest City		Houmt Souk center, approx. 20 km
Doctor	✓	
Football Grounds	✓	
Golf Course	✓	Within 5km
Shopping Options		Midoun center, approx. 6 km
Tennis Court	✓	

**FOR INTERNAL USE ONLY.****ACCEPTED PAYMENT METHODS**

American Express	✓
Maestro	✓
Master/EuroCard	✓
TUI Card	✓
VISA	✓

**GENERAL SECURITY & SAFETY**

CCTV	✓
Emergency Exit on Every Floor	✓
Fire Certificate	✓
Fire Detector	✓
Hotel Staff Trained in Case of Emergencies	✓
Illumination in Park	✓
Security Personnel	✓
Smoke Detector	✓
Sprinkler	✓
Ventilated Staircases	✓

FOR INTERNAL USE ONLY.

HOTEL ACCESSIBILITY

Adapted Rooms

Notes

ADAPTED ROOMS - DOORS WIDTHS

ENTRANCE/DOOR WIDTH

FACILITY HOTEL IN GENERAL

Possibility to Rent a Wheelchair (rate per week) X 0\_value

HOTEL ACCESSIBILITY OF PUBLIC AREAS

HOTEL ACCESSIBILITY OF SWIMMING POOL

HOTEL LOCATION AND ENVIRONMENT

STANDARD ROOM FACILITIES

Standard Room Facilities included